



RIVAGE

BAL HARBOUR

A 2

4 BEDROOMS
 5 BATHROOMS
 2 POWDER ROOMS
 DEN / SERVICE
 OFFICE / GYM

INTERIOR
 4,784 SF | 444 SQM

EXTERIOR
 380 SF | 35 SQM

TOTAL
 5,164 SF | 479 SQM

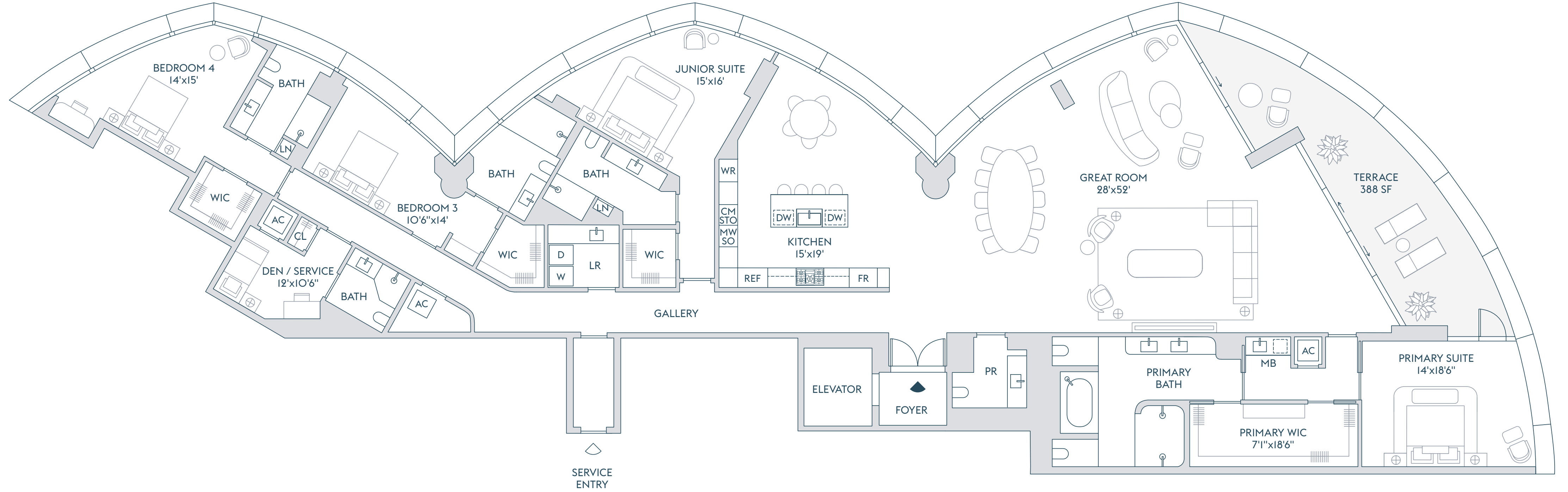

INTRACOASTAL
 WATERS

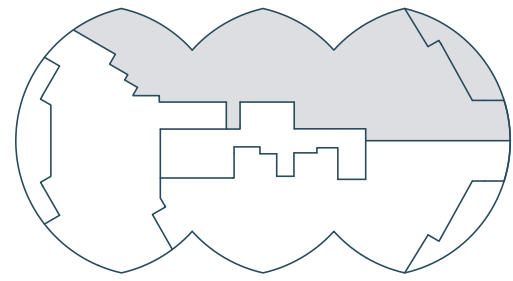

ATLANTIC OCEAN

The dimensions stated for this Unit floor plan are approximate because there are various recognized methods for calculating the square footage of a Unit. The square footage stated herein is calculated from the exterior boundaries of the exterior walls to the centerline of interior demising walls without deductions for cutouts, curves, or architectural features. This method typically results in quoted dimensions greater than the dimensions that would be determined by using other accepted methods. The definition of "Unit" and the calculation method to be relied upon is the method of calculation set forth by the Developer in the Developer's prospectus, which method may result in a square footage calculation that is less than the method used herein. Dimensions and Unit configurations are not guaranteed and may change during construction. Depictions of furnishings, fixtures, and other items of personal property are not included with purchase. Uses of space depicted are not guaranteed. Consult the Developer's prospectus to learn Unit dimensions, what is offered with the Unit, and all terms and conditions. 2022 © Carlton Terrace Owner LLC, with all rights reserved.

A 3-17

4 BEDROOMS
 5 BATHROOMS
 2 POWDER ROOMS
 DEN / SERVICE
 OFFICE / GYM

INTERIOR
 4,810 SF | 446.5 SQM

EXTERIOR
 380 SF | 35 SQM

TOTAL
 5,190 SF | 481.5 SQM

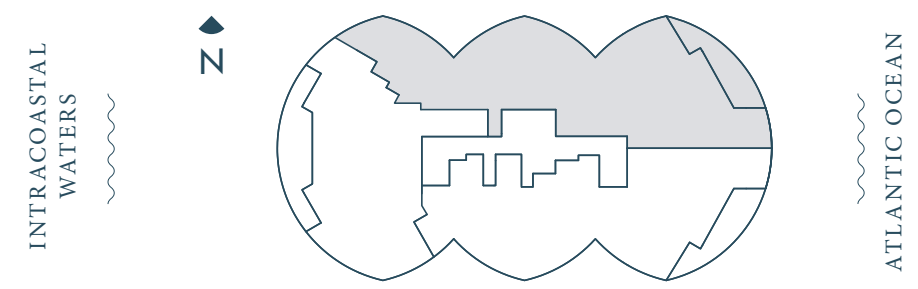
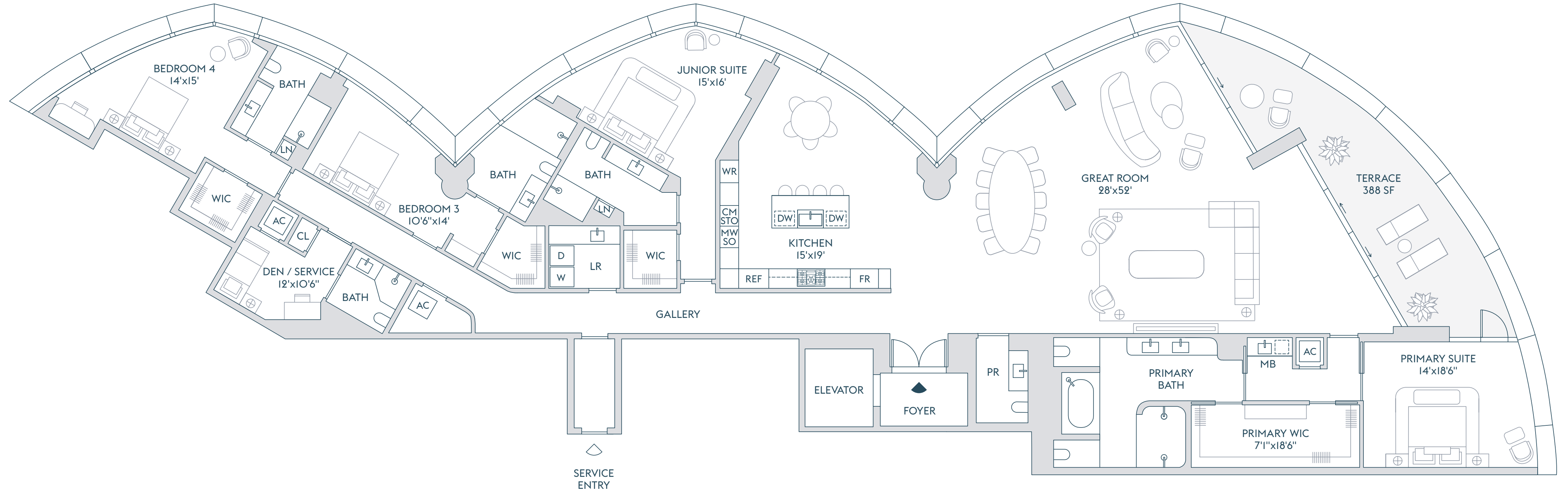

The dimensions stated for this Unit floor plan are approximate because there are various recognized methods for calculating the square footage of a Unit. The square footage stated herein is calculated from the exterior boundaries of the exterior walls to the centerline of interior demising walls without deductions for cutouts, curves, or architectural features. This method typically results in quoted dimensions greater than the dimensions that would be determined by using other accepted methods. The definition of "Unit" and the calculation method to be relied upon is the method of calculation set forth by the Developer in the Developer's prospectus, which method may result in a square footage calculation that is less than the method used herein. Dimensions and Unit configurations are not guaranteed and may change during construction. Depictions of furnishings, fixtures, and other items of personal property are not included with purchase. Uses of space depicted are not guaranteed. Consult the Developer's prospectus to learn Unit dimensions, what is offered with the Unit, and all terms and conditions. 2022 © Carlton Terrace Owner LLC, with all rights reserved.

B 2

4 BEDROOMS
 5 BATHROOMS
 1 POWDER ROOM
 DEN / SERVICE

INTERIOR
 4,215 SF | 391.5 SQM

EXTERIOR
 387 SF | 36 SQM

TOTAL
 4,602 SF | 427.5 SQM

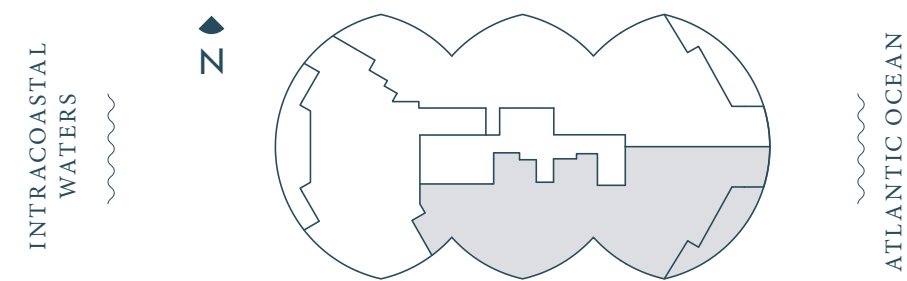
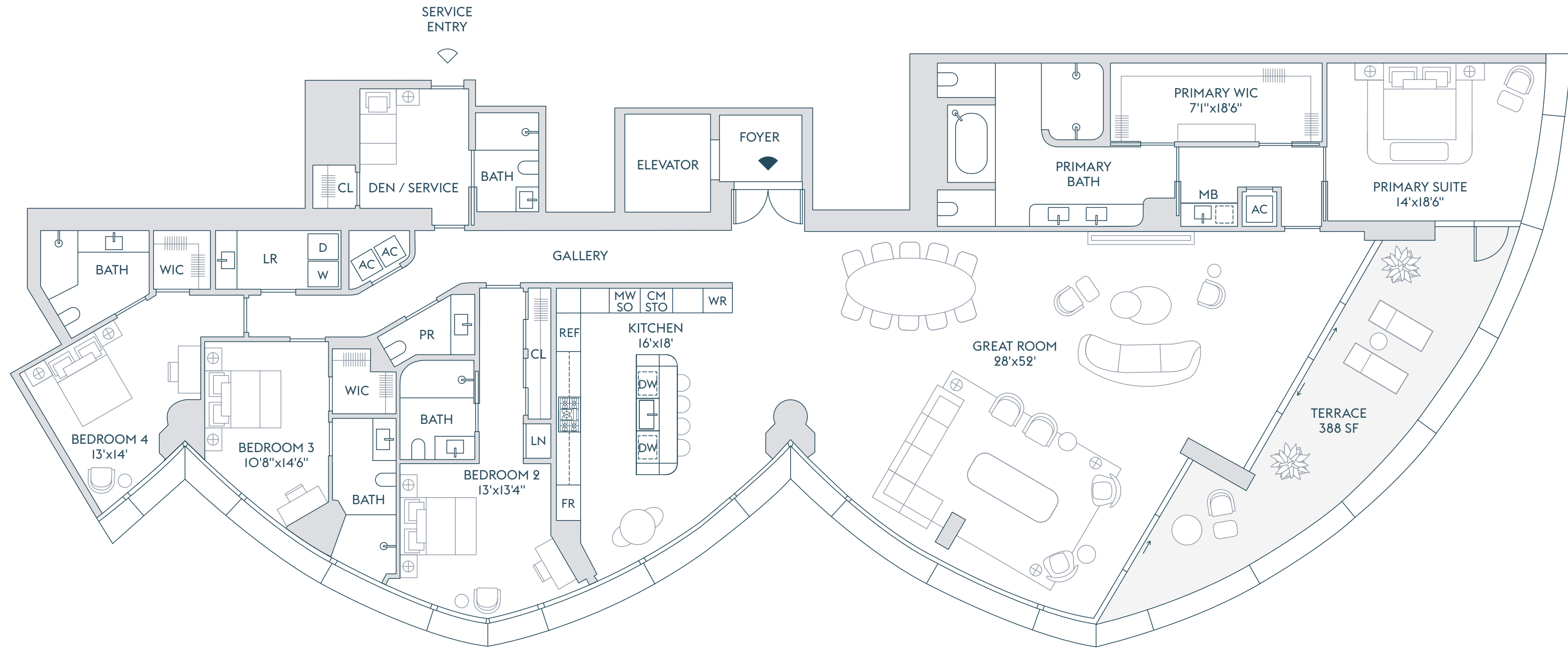

The dimensions stated for this Unit floor plan are approximate because there are various recognized methods for calculating the square footage of a Unit. The square footage stated herein is calculated from the exterior boundaries of the exterior walls to the centerline of interior demising walls without deductions for cutouts, curves, or architectural features. This method typically results in quoted dimensions greater than the dimensions that would be determined by using other accepted methods. The definition of "Unit" and the calculation method to be relied upon is the method of calculation set forth by the Developer in the Developer's prospectus, which method may result in a square footage calculation that is less than the method used herein. Dimensions and Unit configurations are not guaranteed and may change during construction. Depictions of furnishings, fixtures, and other items of personal property are not included with purchase. Uses of space depicted are not guaranteed. Consult the Developer's prospectus to learn Unit dimensions, what is offered with the Unit, and all terms and conditions. 2022 © Carlton Terrace Owner LLC, with all rights reserved.

RESIDENCE

FLOORS

B

3-17

4 BEDROOMS
5 BATHROOMS
1 POWDER ROOM
DEN / SERVICE

INTERIOR
4,358 SF | 404.5 SQM

EXTERIOR
387 SF | 36 SQM

TOTAL
4,745 SF | 440.5 SQM

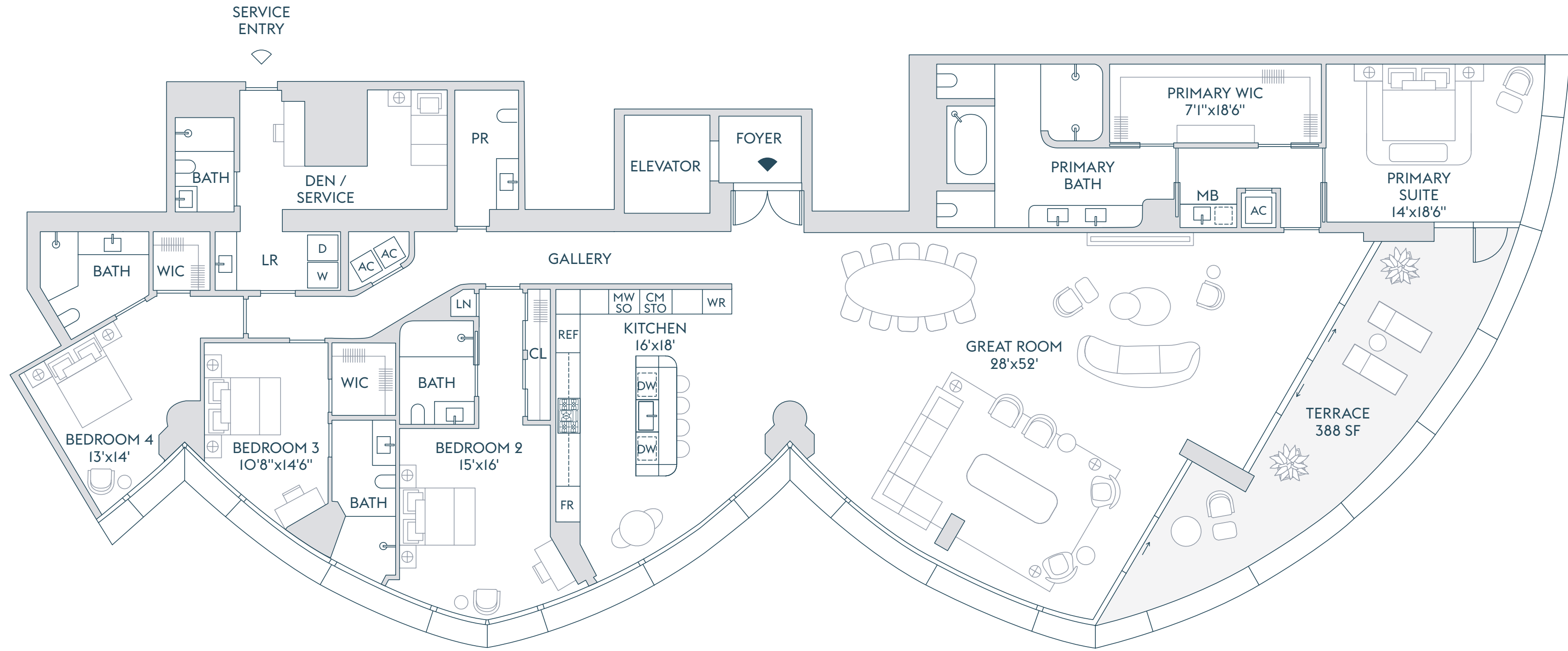

INTRACOASTAL
WATERS

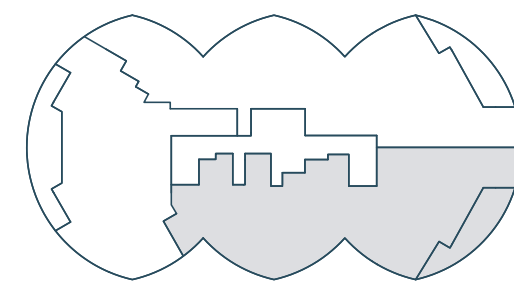

ATLANTIC OCEAN

The dimensions stated for this Unit floor plan are approximate because there are various recognized methods for calculating the square footage of a Unit. The square footage stated herein is calculated from the exterior boundaries of the exterior walls to the centerline of interior demising walls without deductions for cutouts, curves, or architectural features. This method typically results in quoted dimensions greater than the dimensions that would be determined by using other accepted methods. The definition of "Unit" and the calculation method to be relied upon is the method of calculation set forth by the Developer in the Developer's prospectus, which method may result in a square footage calculation that is less than the method used herein. Dimensions and Unit configurations are not guaranteed and may change during construction. Depictions of furnishings, fixtures, and other items of personal property are not included with purchase. Uses of space depicted are not guaranteed. Consult the Developer's prospectus to learn Unit dimensions, what is offered with the Unit, and all terms and conditions. 2022 © Carlton Terrace Owner LLC, with all rights reserved.

RESIDENCE FLOOR

C 2

3 BEDROOMS
3 BATHROOMS
1 POWDER ROOM
OFFICE / DEN

INTERIOR
3,284 SF | 305 SQM

EXTERIOR
585 SF | 54 SQM

TOTAL
3,869 SF | 359 SQM

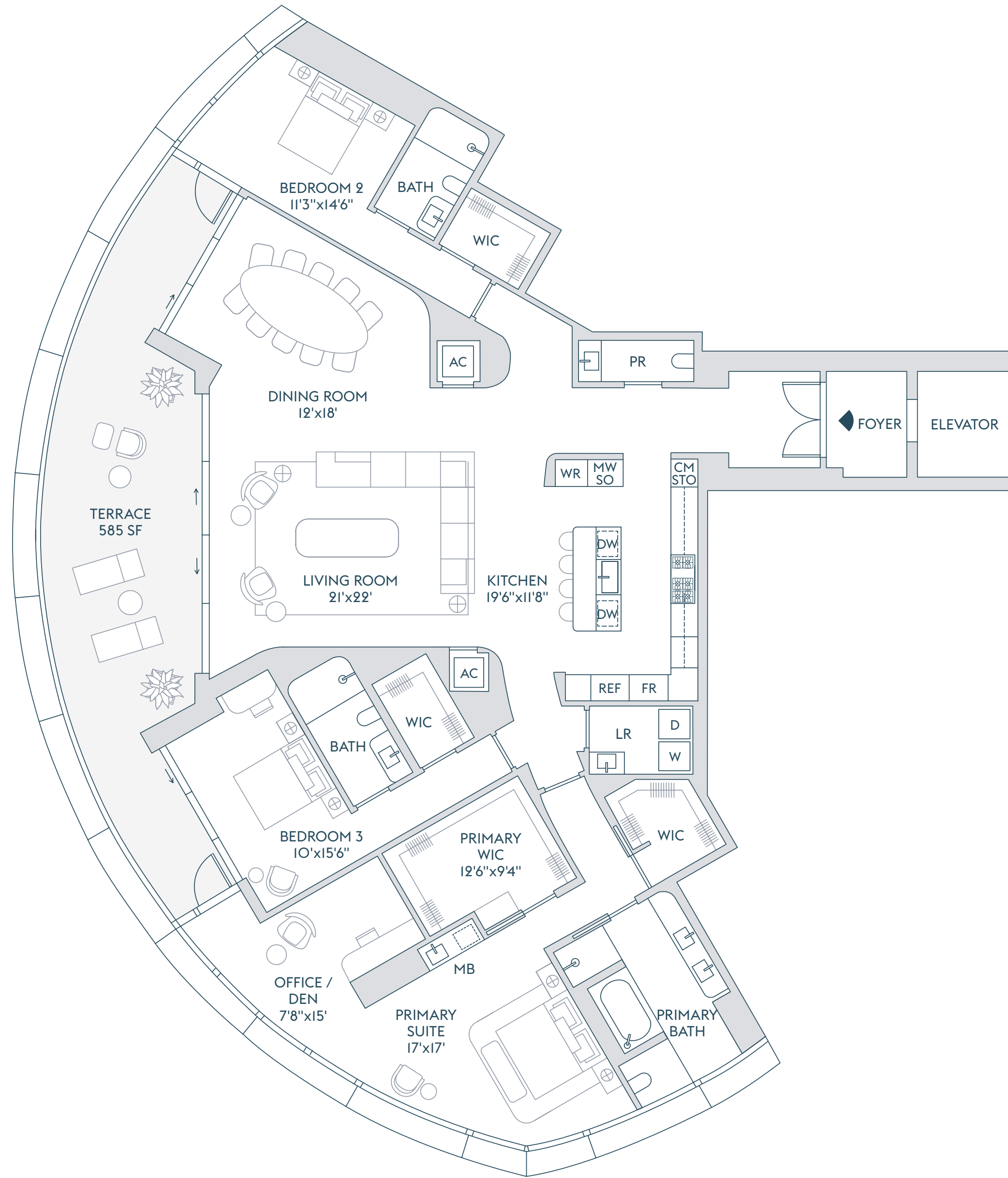

INTRACOASTAL
WATERS

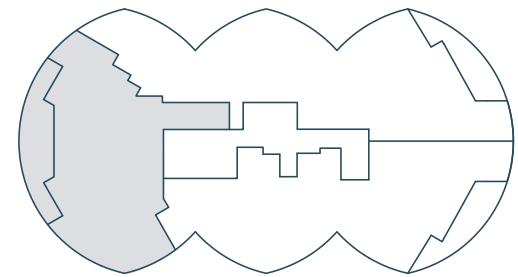

ATLANTIC OCEAN

The dimensions stated for this Unit floor plan are approximate because there are various recognized methods for calculating the square footage of a Unit. The square footage stated herein is calculated from the exterior boundaries of the exterior walls to the centerline of interior demising walls without deductions for cutouts, curves, or architectural features. This method typically results in quoted dimensions greater than the dimensions that would be determined by using other accepted methods. The definition of "Unit" and the calculation method to be relied upon is the method of calculation set forth by the Developer in the Developer's prospectus, which method may result in a square footage calculation that is less than the method used herein. Dimensions and Unit configurations are not guaranteed and may change during construction. Depictions of furnishings, fixtures, and other items of personal property are not included with purchase. Uses of space depicted are not guaranteed. Consult the Developer's prospectus to learn Unit dimensions, what is offered with the Unit, and all terms and conditions. 2022 © Carlton Terrace Owner LLC, with all rights reserved.

RESIDENCE

FLOORS

C

3-17

3 BEDROOMS
3 BATHROOMS
1 POWDER ROOM
OFFICE / DEN

INTERIOR
3,297 SF | 306.5 SQM

EXTERIOR
585 SF | 54 SQM

TOTAL
3,882 SF | 360.5 SQM

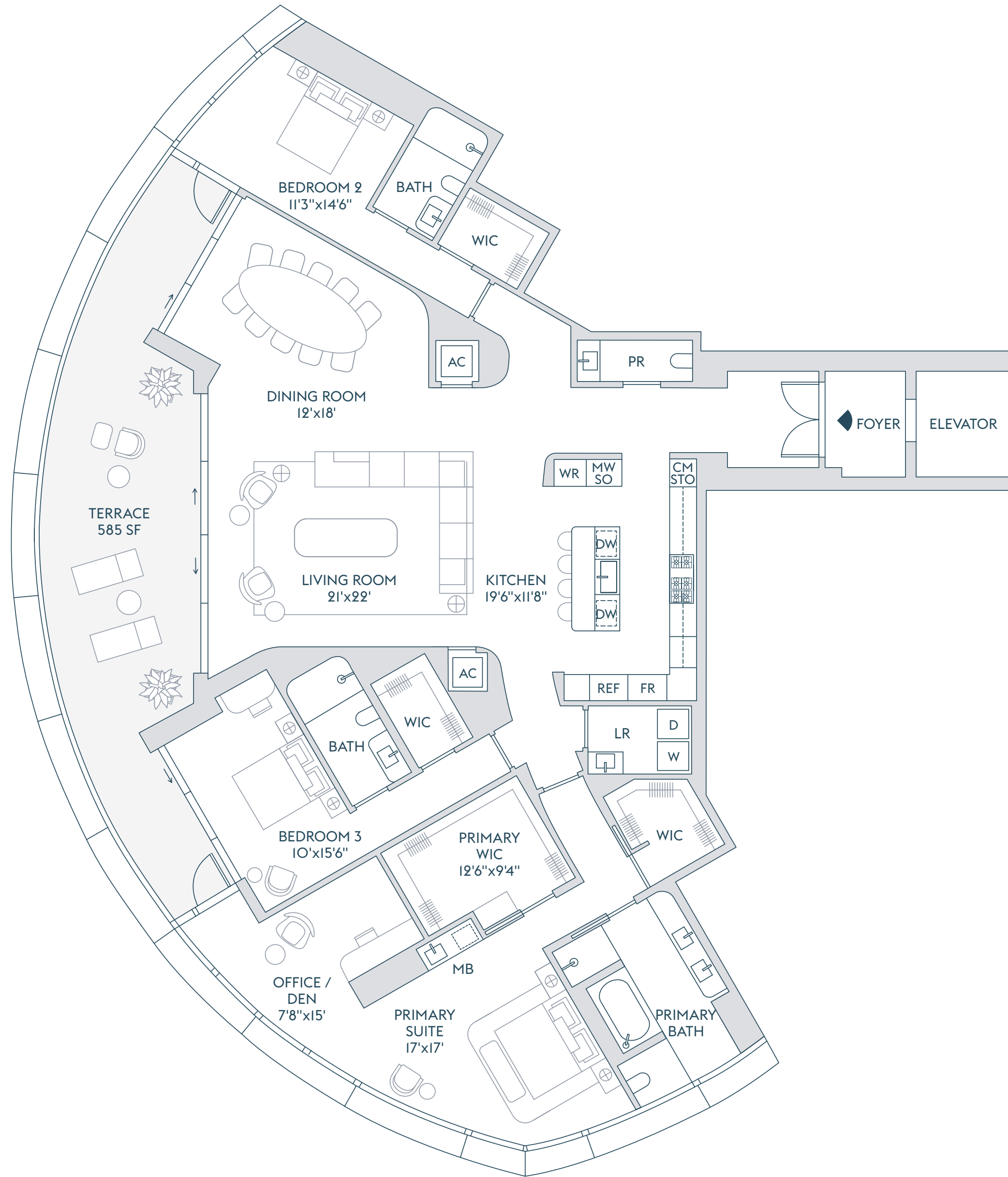

INTRACOASTAL WATERS

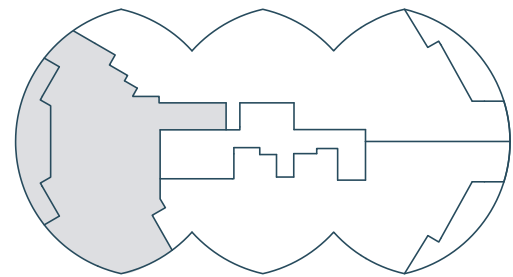

ATLANTIC OCEAN

The dimensions stated for this Unit floor plan are approximate because there are various recognized methods for calculating the square footage of a Unit. The square footage stated herein is calculated from the exterior boundaries of the exterior walls to the centerline of interior demising walls without deductions for cutouts, curves, or architectural features. This method typically results in quoted dimensions greater than the dimensions that would be determined by using other accepted methods. The definition of "Unit" and the calculation method to be relied upon is the method of calculation set forth by the Developer in the Developer's prospectus, which method may result in a square footage calculation that is less than the method used herein. Dimensions and Unit configurations are not guaranteed and may change during construction. Depictions of furnishings, fixtures, and other items of personal property are not included with purchase. Uses of space depicted are not guaranteed. Consult the Developer's prospectus to learn Unit dimensions, what is offered with the Unit, and all terms and conditions. 2022 © Carlton Terrace Owner LLC, with all rights reserved.

A 18-21

- 4 BEDROOMS
- 6 BATHROOMS
- POWDER ROOM
- OFFICE / BEDROOM
- FAMILY ROOM
- DEN
- SERVICE

INTERIOR
6,655 SF | 618 SQM

EXTERIOR
876 SF | 81 SQM

TOTAL
7,531 SF | 700 SQM

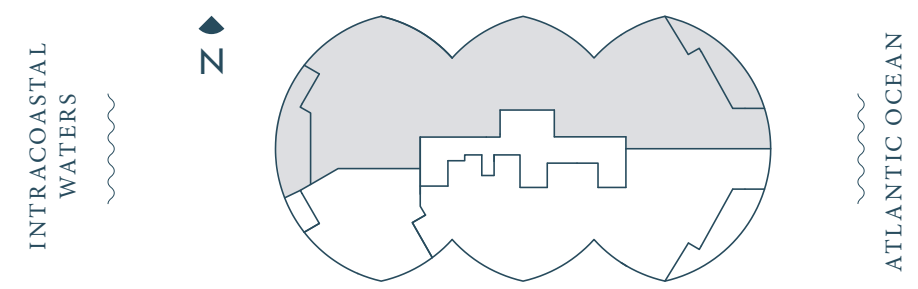
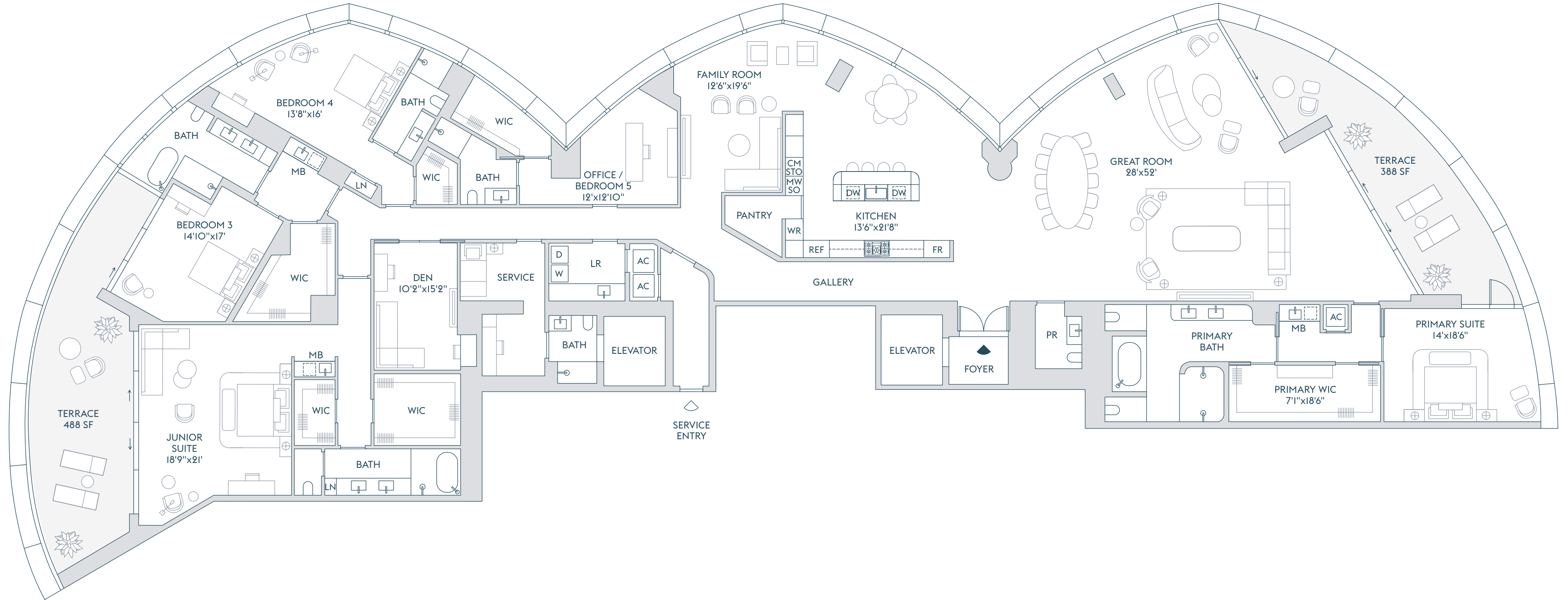

The dimensions stated for this Unit floor plan are approximate because there are various recognized methods for calculating the square footage of a Unit. The square footage stated herein is calculated from the exterior boundaries of the exterior walls to the centerline of interior demising walls without deductions for cutouts, curves, or architectural features. This method typically results in quoted dimensions greater than the dimensions that would be determined by using other accepted methods. The definition of "Unit" and the calculation method to be relied upon is the method of calculation set forth by the Developer in the Developer's prospectus, which method may result in a square footage calculation that is less than the method used herein. Dimensions and Unit configurations are not guaranteed and may change during construction. Depictions of furnishings, fixtures, and other items of personal property are not included with purchase. Uses of space depicted are not guaranteed. Consult the Developer's prospectus to learn Unit dimensions, what is offered with the Unit, and all terms and conditions. 2022 © Carlton Terrace Owner LLC, with all rights reserved.

RESIDENCE

FLOORS

B 18-21

- 4 BEDROOMS
- 6 BATHROOMS
- POWDER ROOM
- OFFICE / BEDROOM
- FAMILY ROOM
- DEN
- SERVICE

INTERIOR
5,810 SF | 540 SQM

EXTERIOR
485 SF | 45 SQM

TOTAL
6,295 SF | 585 SQM

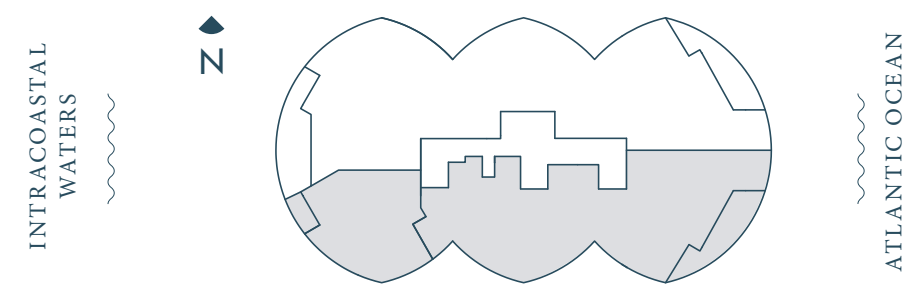
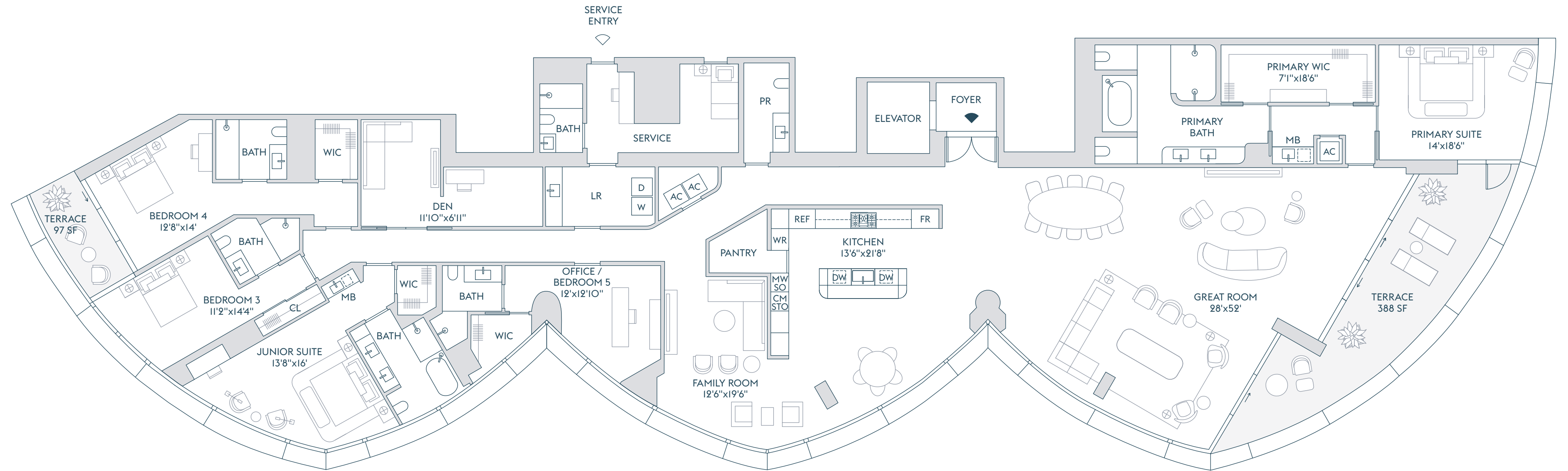

The dimensions stated for this Unit floor plan are approximate because there are various recognized methods for calculating the square footage of a Unit. The square footage stated herein is calculated from the exterior boundaries of the exterior walls to the centerline of interior demising walls without deductions for cutouts, curves, or architectural features. This method typically results in quoted dimensions greater than the dimensions that would be determined by using other accepted methods. The definition of "Unit" and the calculation method to be relied upon is the method of calculation set forth by the Developer in the Developer's prospectus, which method may result in a square footage calculation that is less than the method used herein. Dimensions and Unit configurations are not guaranteed and may change during construction. Depictions of furnishings, fixtures, and other items of personal property are not included with purchase. Uses of space depicted are not guaranteed. Consult the Developer's prospectus to learn Unit dimensions, what is offered with the Unit, and all terms and conditions. 2022 © Carlton Terrace Owner LLC, with all rights reserved.

A 23, 24, 25

- 5 BEDROOMS
- 7 BATHROOMS
- 3 POWDER ROOMS
- DEN / SERVICE
- MEDIA ROOM
- GAME ROOM
- LIBRARY / LOUNGE
- FITNESS STUDIO
- OUTDOOR KITCHEN
- POOL
- PRIVATE ELEVATOR

INTERIOR
12,603 SF | 1,171 SQM

EXTERIOR
4,918 SF | 457 SQM

TOTAL
17,521 SF | 1,628 SQM

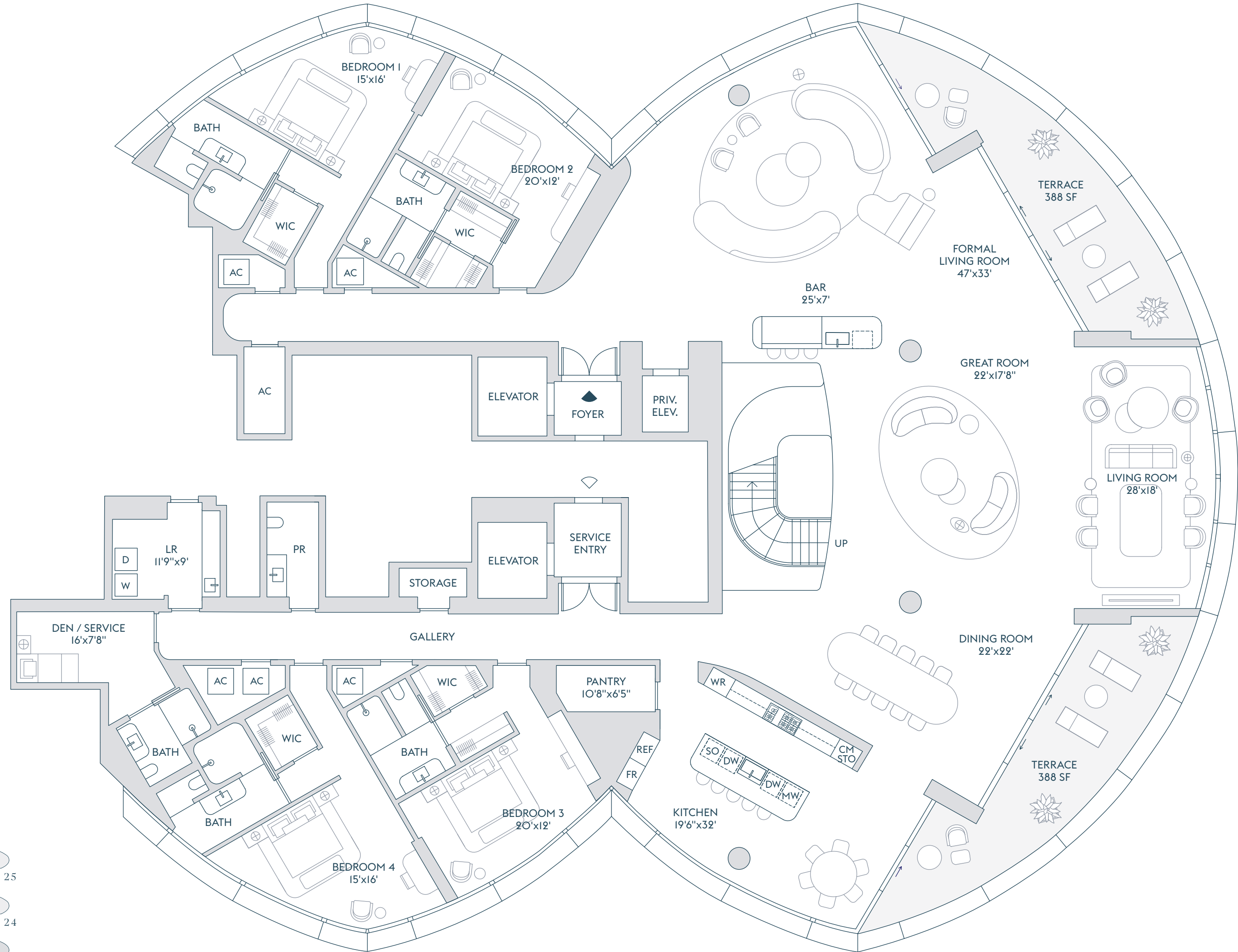

INTRACOASTAL
WATERS

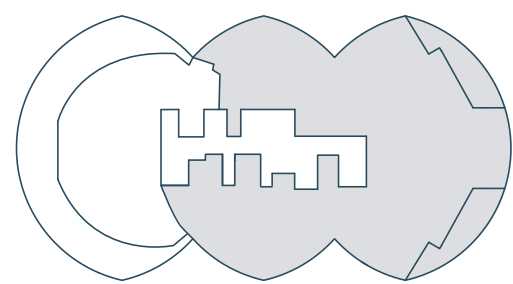

ATLANTIC OCEAN

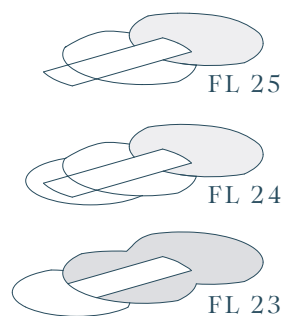

FLOOR 23

The dimensions stated for this Unit floor plan are approximate because there are various recognized methods for calculating the square footage of a Unit. The square footage stated herein is calculated from the exterior boundaries of the exterior walls to the centerline of interior demising walls without deductions for cutouts, curves, or architectural features. This method typically results in quoted dimensions greater than the dimensions that would be determined by using other accepted methods. The definition of "Unit" and the calculation method to be relied upon is the method of calculation set forth by the Developer in the Developer's prospectus, which method may result in a square footage calculation that is less than the method used herein. Dimensions and Unit configurations are not guaranteed and may change during construction. Depictions of furnishings, fixtures, and other items of personal property are not included with purchase. Uses of space depicted are not guaranteed. Consult the Developer's prospectus to learn Unit dimensions, what is offered with the Unit, and all terms and conditions. 2022 © Carlton Terrace Owner LLC, with all rights reserved.

A 23, 24, 25

- 5 BEDROOMS
- 7 BATHROOMS
- 3 POWDER ROOMS
- DEN / SERVICE
- MEDIA ROOM
- GAME ROOM
- LIBRARY / LOUNGE
- FITNESS STUDIO
- OUTDOOR KITCHEN
- POOL
- PRIVATE ELEVATOR

INTERIOR
12,603 SF | 1,171 SQM

EXTERIOR
4,918 SF | 457 SQM

TOTAL
17,521 SF | 1,628 SQM

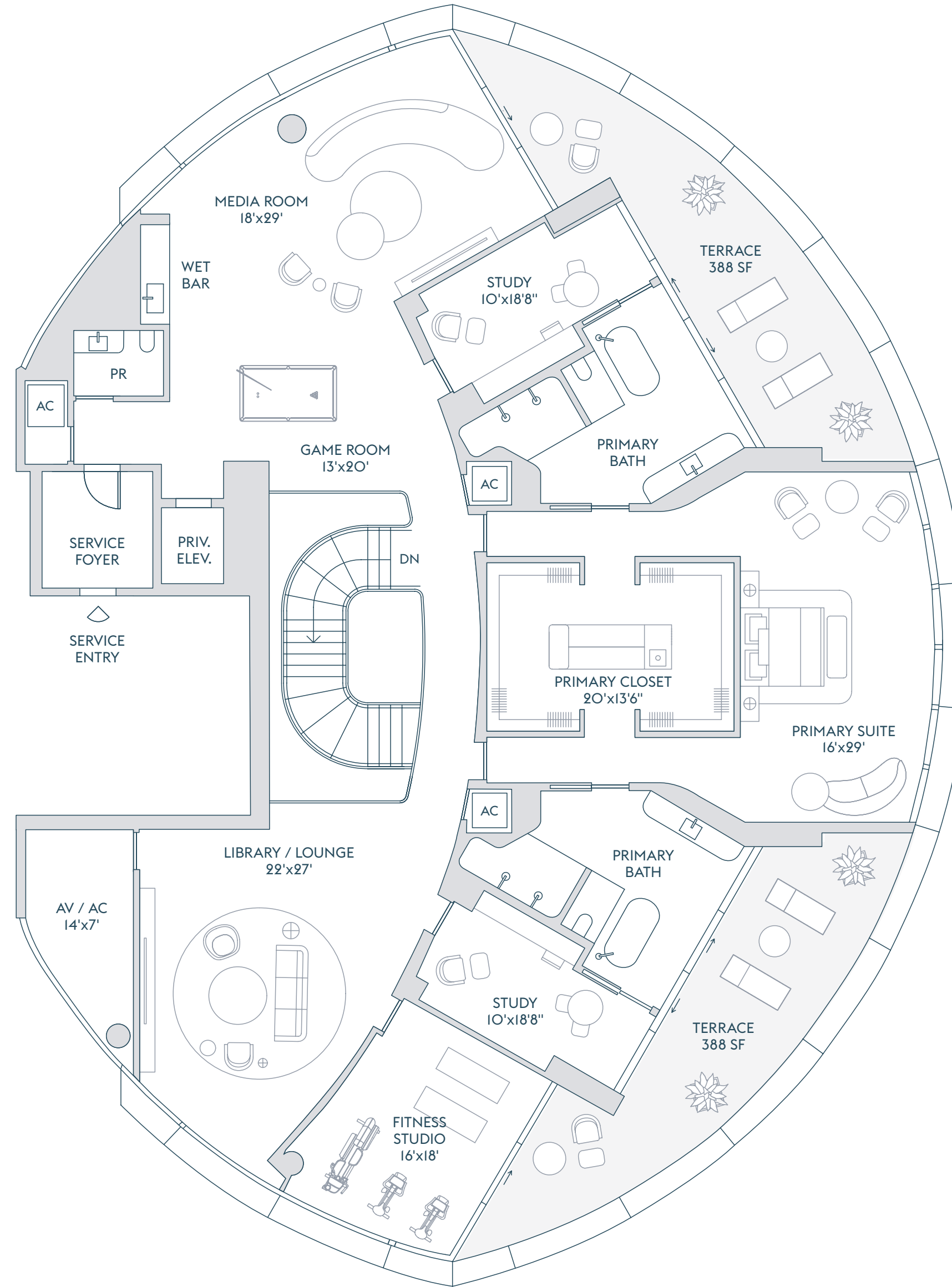

INTRACOASTAL
WATERS

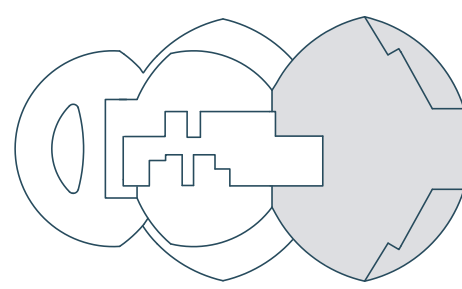

ATLANTIC OCEAN

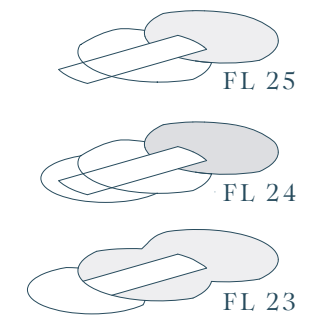

FLOOR 24

The dimensions stated for this Unit floor plan are approximate because there are various recognized methods for calculating the square footage of a Unit. The square footage stated herein is calculated from the exterior boundaries of the exterior walls to the centerline of interior demising walls without deductions for cutouts, curves, or architectural features. This method typically results in quoted dimensions greater than the dimensions that would be determined by using other accepted methods. The definition of "Unit" and the calculation method to be relied upon is the method of calculation set forth by the Developer in the Developer's prospectus, which method may result in a square footage calculation that is less than the method used herein. Dimensions and Unit configurations are not guaranteed and may change during construction. Depictions of furnishings, fixtures, and other items of personal property are not included with purchase. Uses of space depicted are not guaranteed. Consult the Developer's prospectus to learn Unit dimensions, what is offered with the Unit, and all terms and conditions. 2022 © Carlton Terrace Owner LLC, with all rights reserved.

A 23, 24, 25

- 5 BEDROOMS
- 7 BATHROOMS
- 3 POWDER ROOMS
- DEN / SERVICE
- MEDIA ROOM
- GAME ROOM
- LIBRARY / LOUNGE
- FITNESS STUDIO
- OUTDOOR KITCHEN
- POOL
- PRIVATE ELEVATOR

INTERIOR
12,603 SF | 1,171 SQM

EXTERIOR
4,918 SF | 457 SQM

TOTAL
17,521 SF | 1,628 SQM

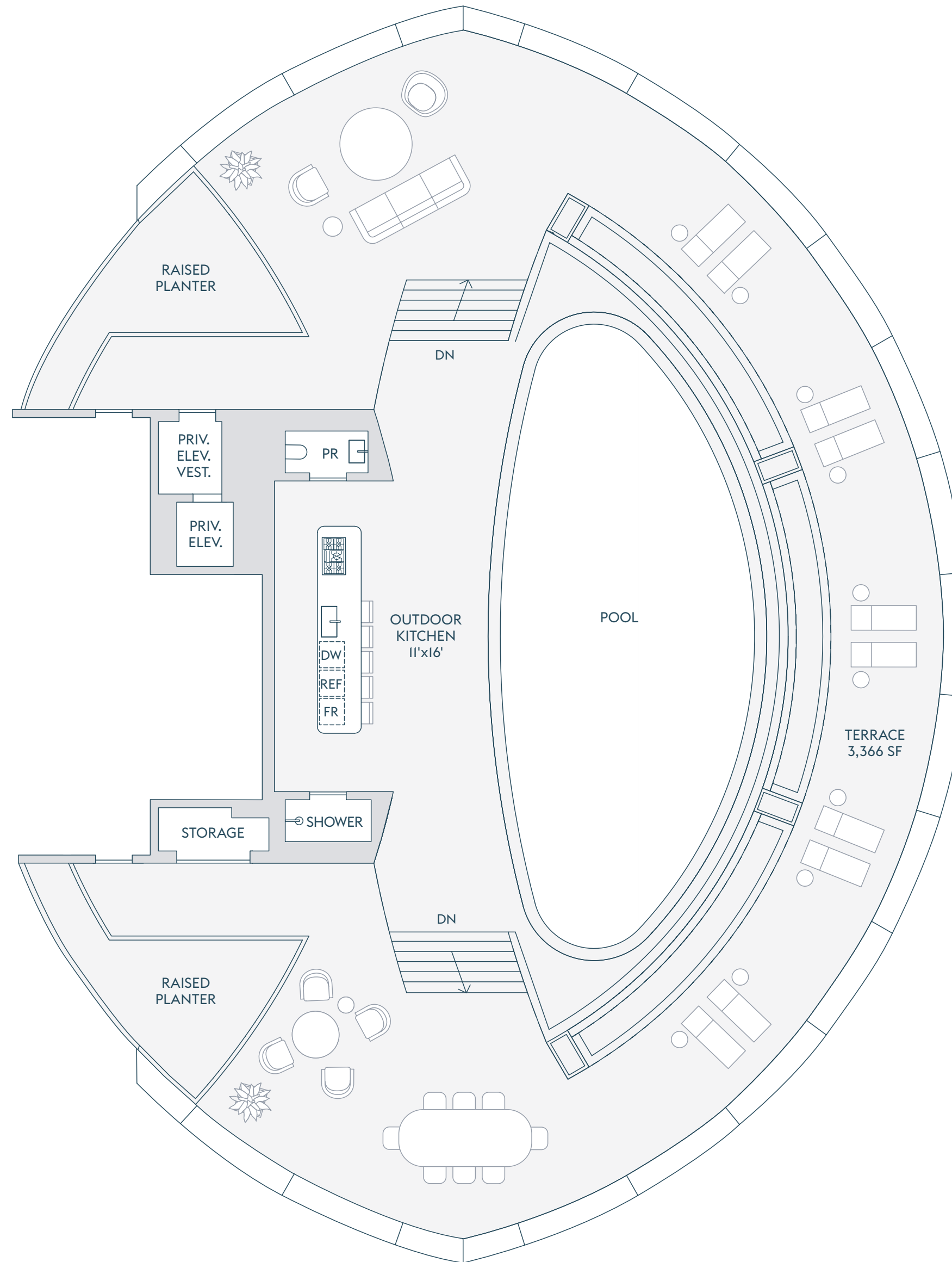

INTRACOASTAL
WATERS

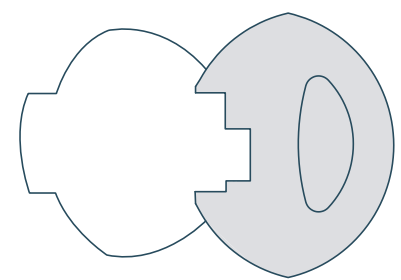

ATLANTIC OCEAN

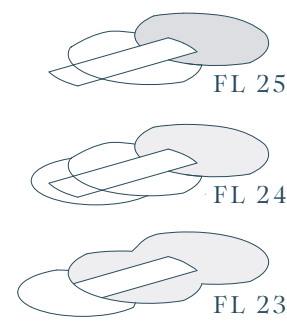

FLOOR 25

The dimensions stated for this Unit floor plan are approximate because there are various recognized methods for calculating the square footage of a Unit. The square footage stated herein is calculated from the exterior boundaries of the exterior walls to the centerline of interior demising walls without deductions for cutouts, curves, or architectural features. This method typically results in quoted dimensions greater than the dimensions that would be determined by using other accepted methods. The definition of "Unit" and the calculation method to be relied upon is the method of calculation set forth by the Developer in the Developer's prospectus, which method may result in a square footage calculation that is less than the method used herein. Dimensions and Unit configurations are not guaranteed and may change during construction. Depictions of furnishings, fixtures, and other items of personal property are not included with purchase. Uses of space depicted are not guaranteed. Consult the Developer's prospectus to learn Unit dimensions, what is offered with the Unit, and all terms and conditions. 2022 © Carlton Terrace Owner LLC, with all rights reserved.

C 22, 23, 24

- 5 BEDROOMS
- 9 BATHROOMS
- POWDER ROOM
- 2 DEN / SERVICE
- FAMILY ROOM
- FITNESS STUDIO
- SKY ROOM
- OUTDOOR KITCHEN
- POOL
- PRIVATE ELEVATOR

INTERIOR
8,677 SF | 806 SQM

EXTERIOR
4,928 SF | 458 SQM

TOTAL
13,605 SF | 1,264 SQM

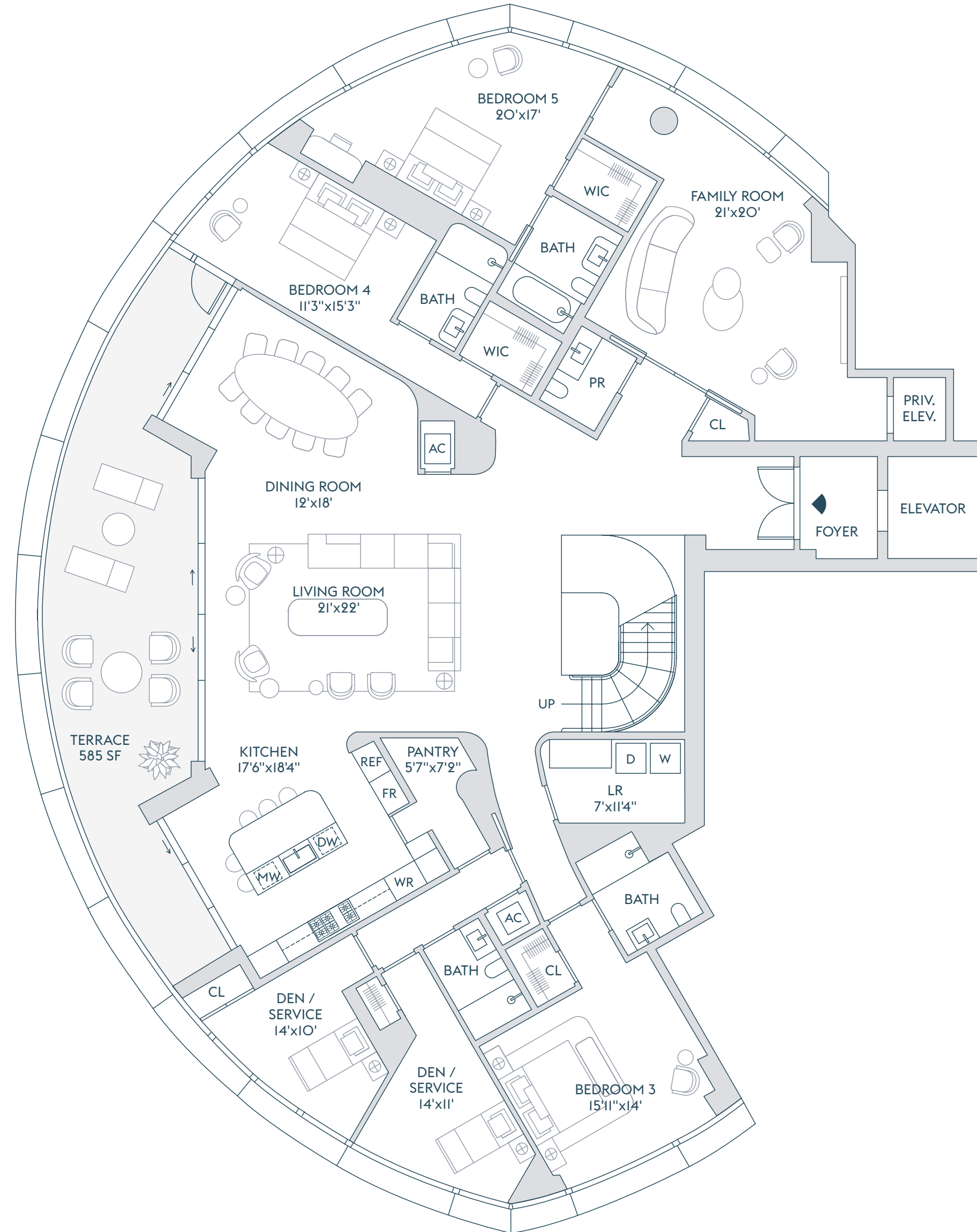

INTRACOASTAL
WATERS

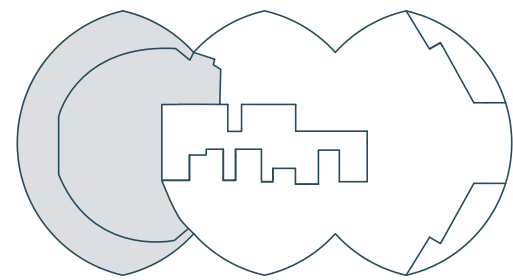

ATLANTIC OCEAN

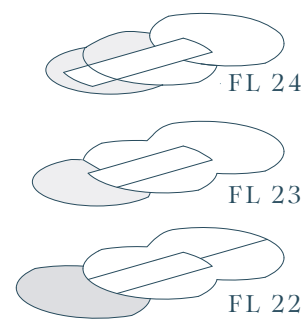

FLOOR 22

The dimensions stated for this Unit floor plan are approximate because there are various recognized methods for calculating the square footage of a Unit. The square footage stated herein is calculated from the exterior boundaries of the exterior walls to the centerline of interior demising walls without deductions for cutouts, curves, or architectural features. This method typically results in quoted dimensions greater than the dimensions that would be determined by using other accepted methods. The definition of "Unit" and the calculation method to be relied upon is the method of calculation set forth by the Developer in the Developer's prospectus, which method may result in a square footage calculation that is less than the method used herein. Dimensions and Unit configurations are not guaranteed and may change during construction. Depictions of furnishings, fixtures, and other items of personal property are not included with purchase. Uses of space depicted are not guaranteed. Consult the Developer's prospectus to learn Unit dimensions, what is offered with the Unit, and all terms and conditions. 2022 © Carlton Terrace Owner LLC, with all rights reserved.

BAY
PENTHOUSE FLOORS

C 22, 23, 24

- 5 BEDROOMS
- 9 BATHROOMS
- POWDER ROOM
- 2 DEN / SERVICE
- FAMILY ROOM
- FITNESS STUDIO
- SKY ROOM
- OUTDOOR KITCHEN
- POOL
- PRIVATE ELEVATOR

INTERIOR
8,677 SF | 806 SQM

EXTERIOR
4,928 SF | 458 SQM

TOTAL
13,605 SF | 1,264 SQM

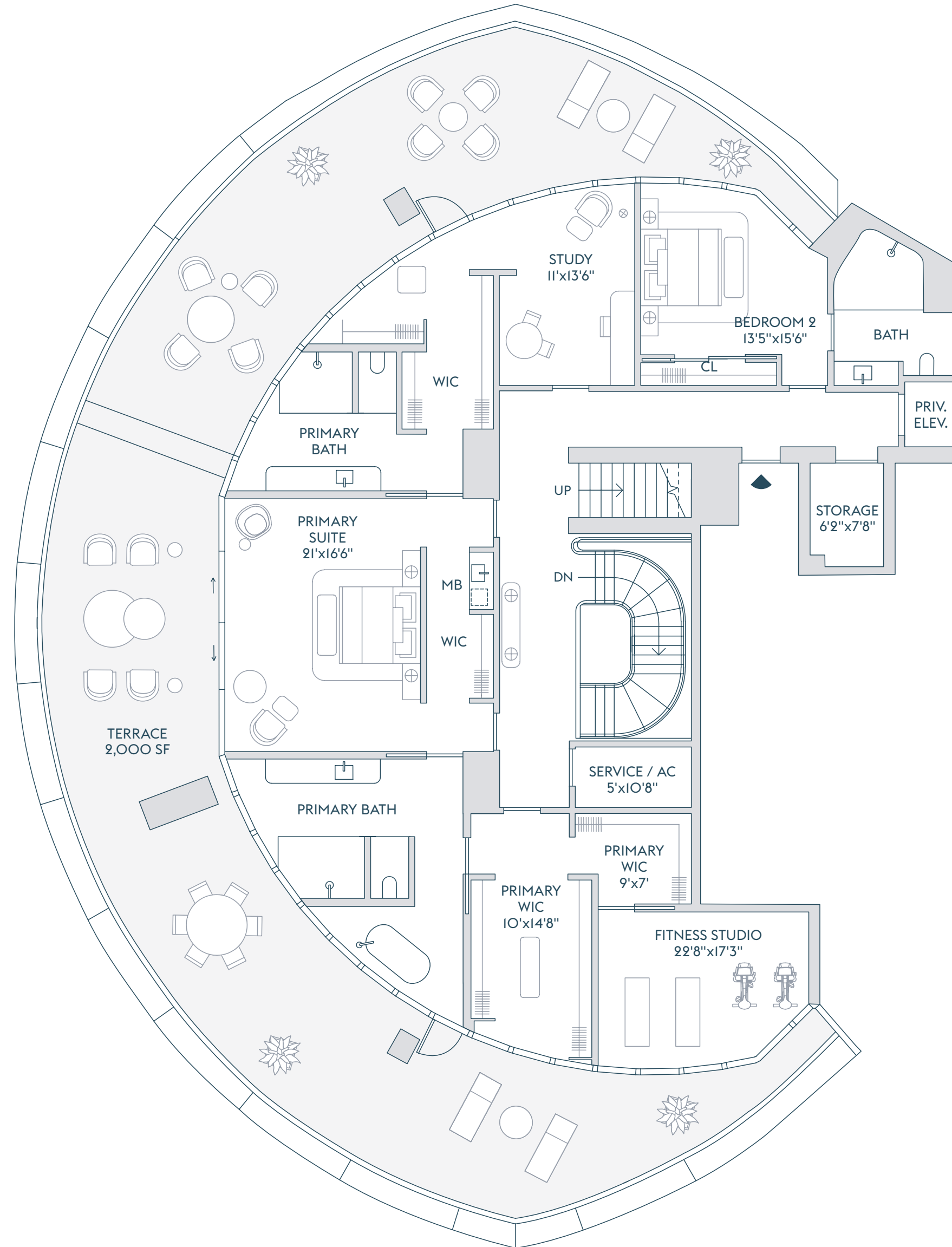

INTRACOASTAL
WATERS

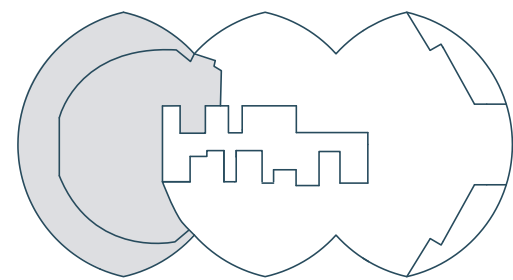

ATLANTIC OCEAN

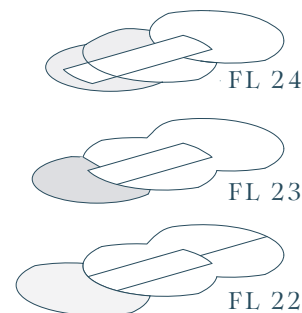

FLOOR 23

The dimensions stated for this Unit floor plan are approximate because there are various recognized methods for calculating the square footage of a Unit. The square footage stated herein is calculated from the exterior boundaries of the exterior walls to the centerline of interior demising walls without deductions for cutouts, curves, or architectural features. This method typically results in quoted dimensions greater than the dimensions that would be determined by using other accepted methods. The definition of "Unit" and the calculation method to be relied upon is the method of calculation set forth by the Developer in the Developer's prospectus, which method may result in a square footage calculation that is less than the method used herein. Dimensions and Unit configurations are not guaranteed and may change during construction. Depictions of furnishings, fixtures, and other items of personal property are not included with purchase. Uses of space depicted are not guaranteed. Consult the Developer's prospectus to learn Unit dimensions, what is offered with the Unit, and all terms and conditions. 2022 © Carlton Terrace Owner LLC, with all rights reserved.

BAY
PENTHOUSE FLOORS

C 22, 23, 24

- 5 BEDROOMS
- 9 BATHROOMS
- POWDER ROOM
- 2 DEN / SERVICE
- FAMILY ROOM
- FITNESS STUDIO
- SKY ROOM
- OUTDOOR KITCHEN
- POOL
- PRIVATE ELEVATOR

INTERIOR
8,677 SF | 806 SQM

EXTERIOR
4,928 SF | 458 SQM

TOTAL
13,605 SF | 1,264 SQM

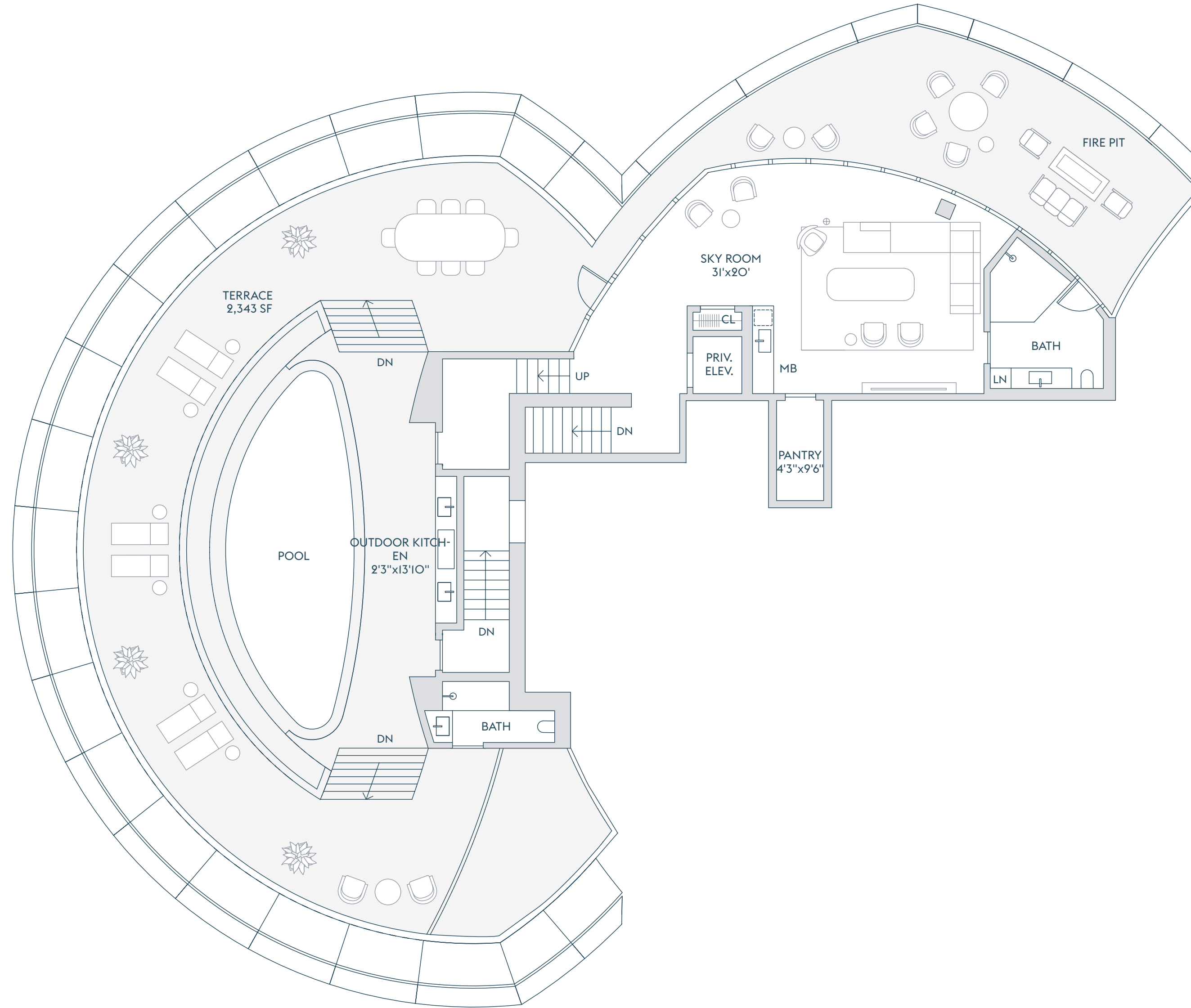

INTRACOASTAL
WATERS

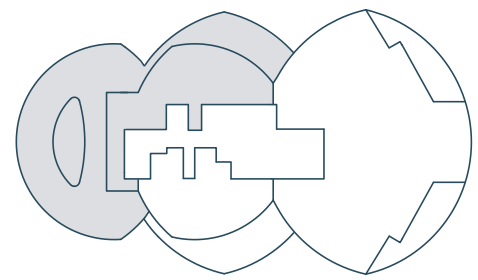

ATLANTIC OCEAN

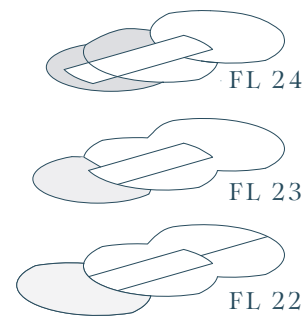

FLOOR 24

The dimensions stated for this Unit floor plan are approximate because there are various recognized methods for calculating the square footage of a Unit. The square footage stated herein is calculated from the exterior boundaries of the exterior walls to the centerline of interior demising walls without deductions for cutouts, curves, or architectural features. This method typically results in quoted dimensions greater than the dimensions that would be determined by using other accepted methods. The definition of "Unit" and the calculation method to be relied upon is the method of calculation set forth by the Developer in the Developer's prospectus, which method may result in a square footage calculation that is less than the method used herein. Dimensions and Unit configurations are not guaranteed and may change during construction. Depictions of furnishings, fixtures, and other items of personal property are not included with purchase. Uses of space depicted are not guaranteed. Consult the Developer's prospectus to learn Unit dimensions, what is offered with the Unit, and all terms and conditions. 2022 © Carlton Terrace Owner LLC, with all rights reserved.

LOWER
PENTHOUSE FLOORS

A 22, 24

- 6 BEDROOMS
- 9 BATHROOMS
- 2 POWDER ROOMS
- DEN
- SERVICE
- FAMILY ROOM
- SKY ROOM
- WINE ROOM
- OUTDOOR KITCHEN
- SPA POOL
- PRIVATE ELEVATOR

INTERIOR
9,464 SF | 879 SQM

EXTERIOR
1,346 SF | 125 SQM

TOTAL
10,810 SF | 1,004 SQM

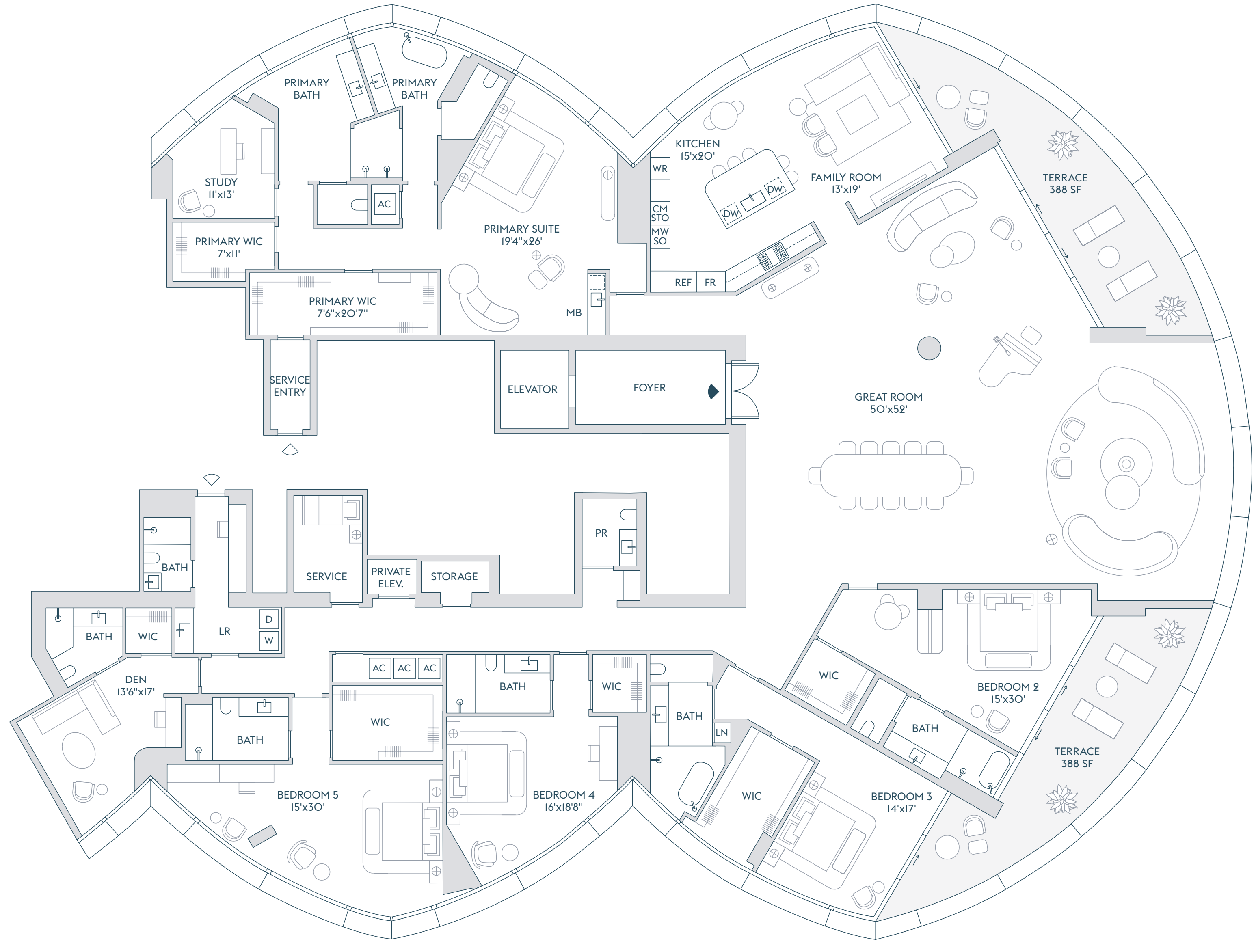

INTRACOASTAL
WATERS

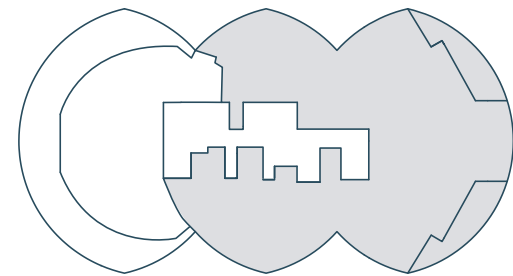

ATLANTIC OCEAN

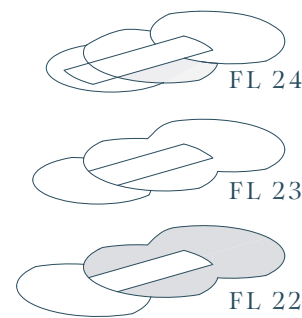

FLOOR 22

The dimensions stated for this Unit floor plan are approximate because there are various recognized methods for calculating the square footage of a Unit. The square footage stated herein is calculated from the exterior boundaries of the exterior walls to the centerline of interior demising walls without deductions for cutouts, curves, or architectural features. This method typically results in quoted dimensions greater than the dimensions that would be determined by using other accepted methods. The definition of "Unit" and the calculation method to be relied upon is the method of calculation set forth by the Developer in the Developer's prospectus, which method may result in a square footage calculation that is less than the method used herein. Dimensions and Unit configurations are not guaranteed and may change during construction. Depictions of furnishings, fixtures, and other items of personal property are not included with purchase. Uses of space depicted are not guaranteed. Consult the Developer's prospectus to learn Unit dimensions, what is offered with the Unit, and all terms and conditions. 2022 © Carlton Terrace Owner LLC, with all rights reserved.

LOWER
PENTHOUSE FLOORS

A 22, 24

- 6 BEDROOMS
- 9 BATHROOMS
- 2 POWDER ROOMS
- DEN
- SERVICE
- FAMILY ROOM
- SKY ROOM
- WINE ROOM
- OUTDOOR KITCHEN
- SPA POOL
- PRIVATE ELEVATOR

INTERIOR
9,464 SF | 879 SQM

EXTERIOR
1,346 SF | 125 SQM

TOTAL
10,810 SF | 1,004 SQM

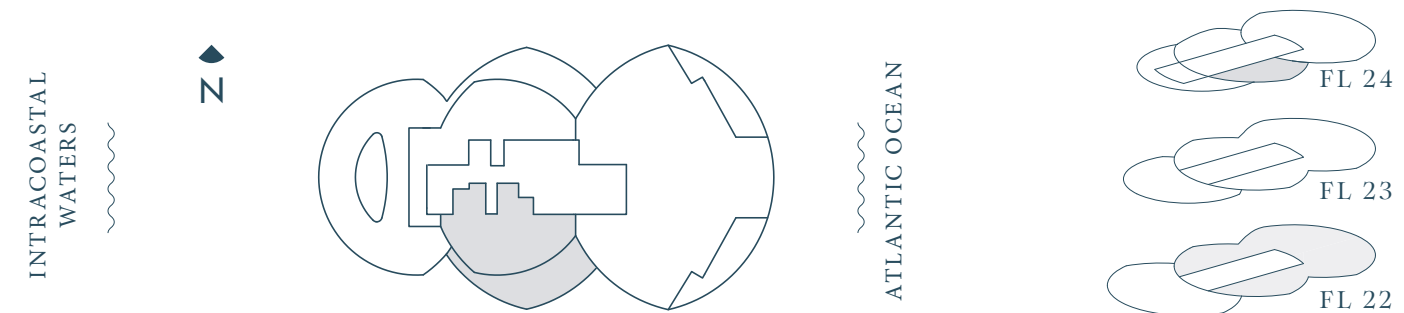
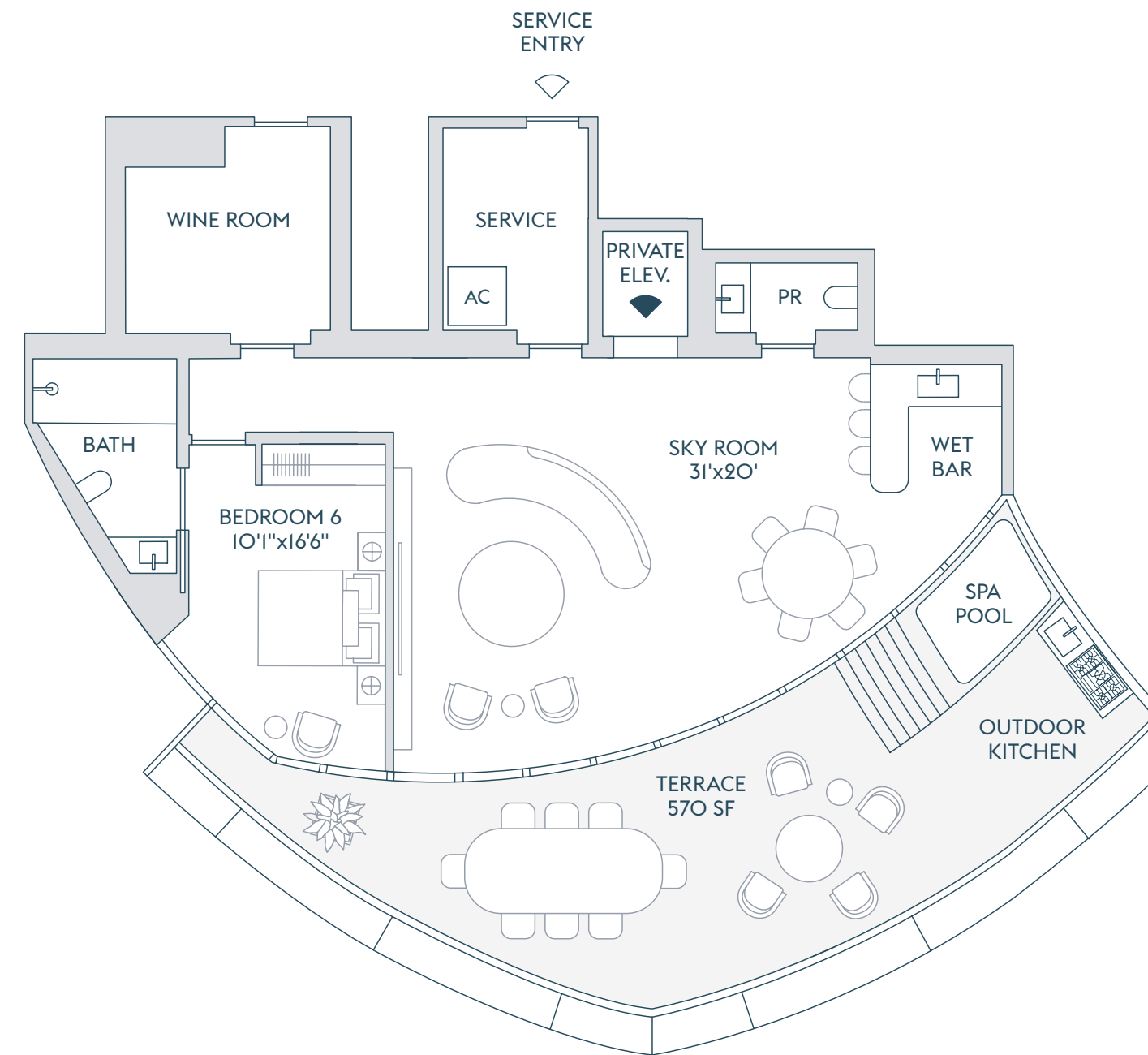

FLOOR 24

The dimensions stated for this Unit floor plan are approximate because there are various recognized methods for calculating the square footage of a Unit. The square footage stated herein is calculated from the exterior boundaries of the exterior walls to the centerline of interior demising walls without deductions for cutouts, curves, or architectural features. This method typically results in quoted dimensions greater than the dimensions that would be determined by using other accepted methods. The definition of "Unit" and the calculation method to be relied upon is the method of calculation set forth by the Developer in the Developer's prospectus, which method may result in a square footage calculation that is less than the method used herein. Dimensions and Unit configurations are not guaranteed and may change during construction. Depictions of furnishings, fixtures, and other items of personal property are not included with purchase. Uses of space depicted are not guaranteed. Consult the Developer's prospectus to learn Unit dimensions, what is offered with the Unit, and all terms and conditions. 2022 © Carlton Terrace Owner LLC, with all rights reserved.



ORAL REPRESENTATIONS CANNOT BE RELIED UPON AS CORRECTLY STATING THE REPRESENTATIONS OF THE DEVELOPER. FOR CORRECT REPRESENTATIONS, MAKE REFERENCE TO THIS BROCHURE AND TO THE DOCUMENTS REQUIRED BY SECTION 718.503, FLORIDA STATUTES, TO BE FURNISHED BY A DEVELOPER TO A BUYER OR LESSEE.

RIVAGE BAL HARBOUR CONDOMINIUM (the "Condominium") is developed by Carlton Terrace Owner LLC ("Developer") and this offering is made only by the Developer's Prospectus for the Condominium. Consult the Developer's Prospectus for the proposed budget, terms, conditions, specifications, fees, and Unit dimensions. Sketches, renderings, or photographs depicting lifestyle, amenities, food services, club services, rental services, hosting services, finishes, designs, materials, furnishings, fixtures, appliances, cabinetry, soffits, lighting, countertops, floor plans, specifications, design, or art are proposed only, and the Developer reserves the right to modify, revise, or withdraw any or all of the same in its sole discretion. No specific view is guaranteed. Pursuant to license agreements, Developer also has a right to use the trade names, marks, and logos of: (1) The Related Group; and (2) Two Roads Development, each of which is a licensor. The Developer is not incorporated in, located in, nor a resident of, New York. This is not intended to be an offer to sell, or solicitation of an offer to buy, condominium units in New York or to residents of New York, or of any other jurisdiction where prohibited by law. 2022 © Carlton Terrace Owner LLC, with all rights reserved. ☒